

1/2 mile long & 250 wide west of road right of way Richard Beaver property



City Limits  
Zoned Commercial  
1/2 mile beyond city limits  
Zoned Residential

city maintenance  
truck court

D. Hanson

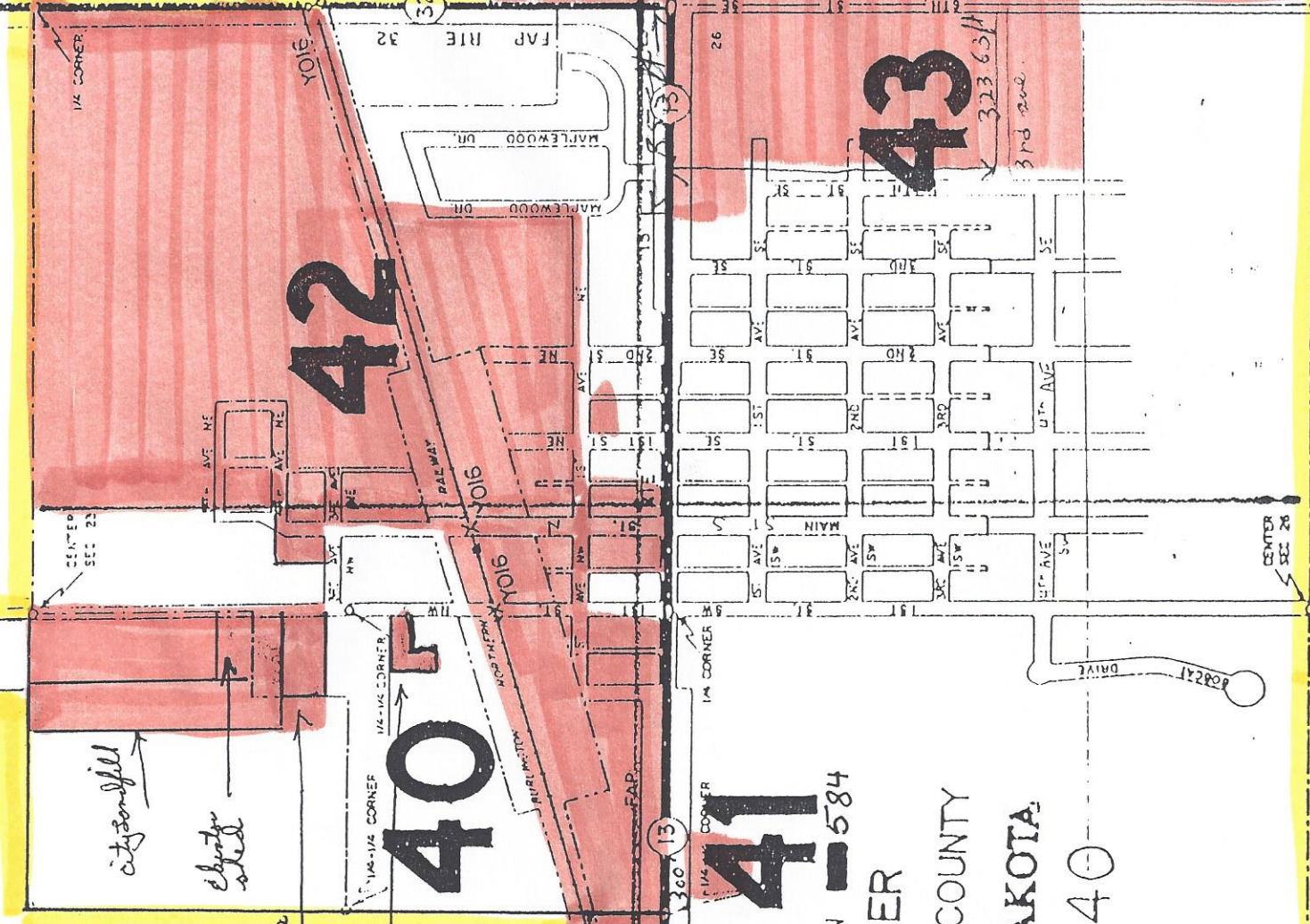

POPULATION 584  
GWINNER  
SARGENT COUNTY  
NORTH DAKOTA  
58040

Highway 13 to Rt centerline  
CORPORATE LIMITS AT CENTERLINE  
T. 132 N., R. 56 W.  
334'  
800'  
1/4 CORNER

7740 east of 1300 13  
CORPORATE LIMITS AT CENTERLINE

2E 1/4 CORNER